

COOLER

INSTALLATION GUIDE

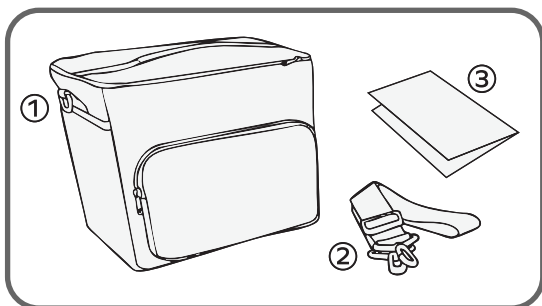

Package included:

1. Cooler: 1 pc
2. Shoulder Strap: 1 pc
3. Instruction Sheet: 1 pc

Product Specification:

Size : W 10.2" X D 13" X H 10.6"

Weight : 1.75lbs

Manufacturer ARSN USA

How to Secure the Cooler

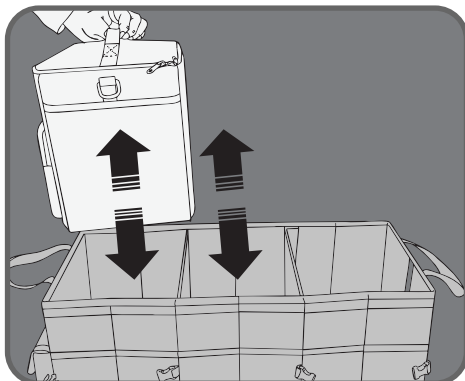
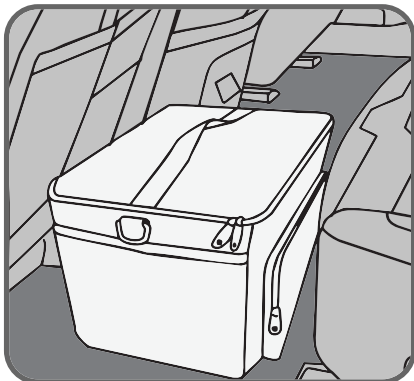

- Keep the cooler under the back seat to grab drinks easily during your drive.

- Easily take the cooler in and out of the cargo organizer.

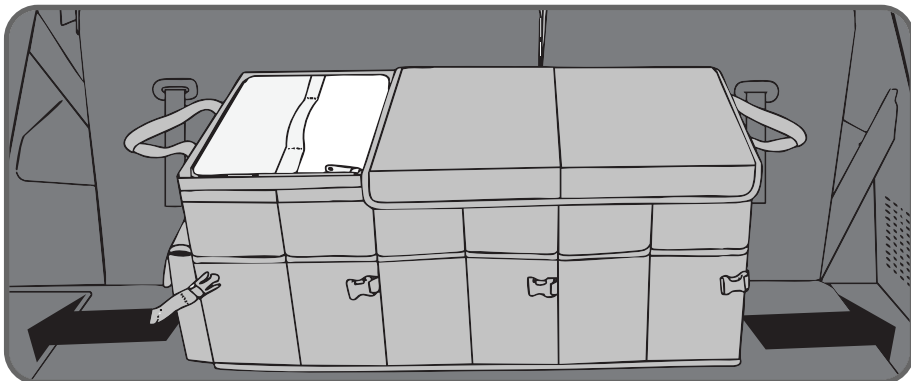

- Store the cooler in a safe place and enjoy a comfortable and safe journey!
(The images above are examples of usage.)

How to Use the Cooler

Follow the steps below to ensure your cooler works effectively and lasts longer.

- Storing drinks and snacks during road trips, picnics, or outdoor activities.
- Transporting groceries that need to stay cool.
- Organizing and carrying items with the included shoulder strap.
- Use the cooler according to the manufacturer's instructions.

Warning

⚠ WARNING : Do not exceed the maximum load capacity of **40 lbs (18 kg)**.

⚠ WARNING : Do not store large, heavy, or sharp objects inside the cooler.

⚠ WARNING : Do not store flammable or chemical substances in the cooler.

For safe travel, **store the cooler below the seat level** in your vehicle or in a secure area where it will not move while driving.

Warranty Information

This product is covered by a one-year limited warranty from the date of purchase. ARSN is responsible for providing all warranty-related services. During the warranty period, ARSN will offer free replacement for any manufacturing defects or malfunctions that occur under normal use. Please retain your purchase receipt and this warranty information for future reference. The warranty covers defects in materials or workmanship under normal conditions. It does not cover damage resulting from misuse, negligence, improper handling, or use in abnormal environments.

Return & Warranty Claim Process

For return or warranty service requests, please contact us at support@arsnusa.com.

After we receive your request, our support team will guide you through the next steps, including return instructions if applicable.

- **Keep the manual in the glove box.**

CLEANING INSTRUCTIONS:

TO CLEAN, SIMPLY WIPE WITH A DAMP TOWEL OR SOFT CLOTH.